

# \$4,550,278 - 2725 & 2753 Goodwin Ln, New Braunfels

MLS® #1332400

## \$4,550,278

Bedroom, Bathroom, 1,736 sqft  
Commercial on 17 Acres

N/A, New Braunfels, TX

17.41+/- unrestricted acres conveniently close to FM 306, HEB Plus, Creekside, and just minutes from Gruene. Zoned M-1A with approx. 650 feet of road frontage allows for endless possibilities. Perfect for an apartment or other multifamily site or plenty of space for a manufacturing operation, industrial complex, RV Park, or athletic fields. City electricity and water on site with public sewer nearby.

Built in 1966

## Essential Information

MLS® #	1332400
Price	\$4,550,278
Square Footage	1,736
Acres	17.41
Year Built	1966
Type	Commercial
Sub-Type	Apts/Retail/Strip/BusPrk
Status	Active

## Community Information

Address	2725 & 2753 Goodwin Ln
Area	2618
Subdivision	N/A
City	New Braunfels
County	Comal
State	TX
Zip Code	78130-7119

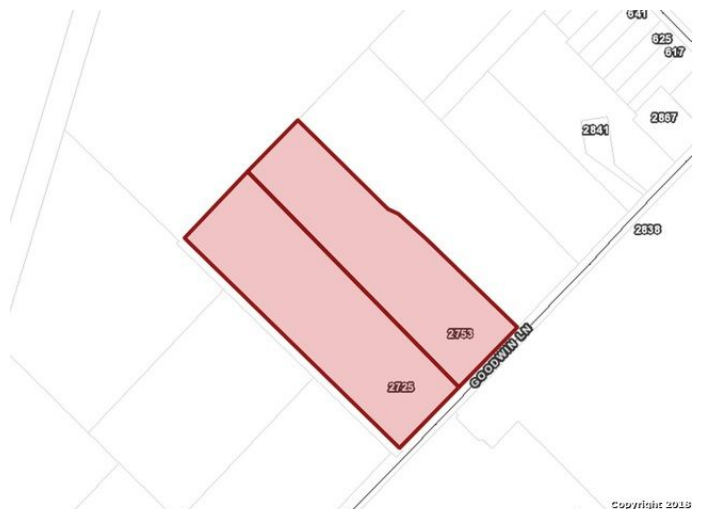

## Amenities

Utilities	Electricity, Septic, Water
Parking Spaces	5

## Interior

Heating	Central
Cooling	Central
# of Stories	1.0
Stories	1

## Exterior

Roof	Composition
Construction	Other

## School Information

District	Comal
----------	-------

## Additional Information

Date Listed	August 14th, 2018
Days on Market	426
Zoning	M-1A

## Listing Details

Listing Office	D. Lee Edwards Realty, Inc
----------------	----------------------------

The data relating to real estate on this web site comes in part from the Internet Data Exchange program of the MLS of the San Antonio Board of Realtors®, and is updated as of October 15th, 2019 at 4:21am CDT (date/time). IDX information is provided exclusively for consumers' personal, non-commercial use and may not be used for any purpose other than to identify prospective properties consumers may be interested in purchasing.