

\$999,000 - 1055 Springdale Rd, Austin

MLS® #8358498

\$999,000

Bedroom, Bathroom, 23,714 sqft
Lot on 1 Acres

Prock G C, Austin, TX

1055 & 1053 Springdale Rd sold together.
Level lot Zoned SF-6, ready for 6 unit
condo/townhouse development in booming
East Austin.

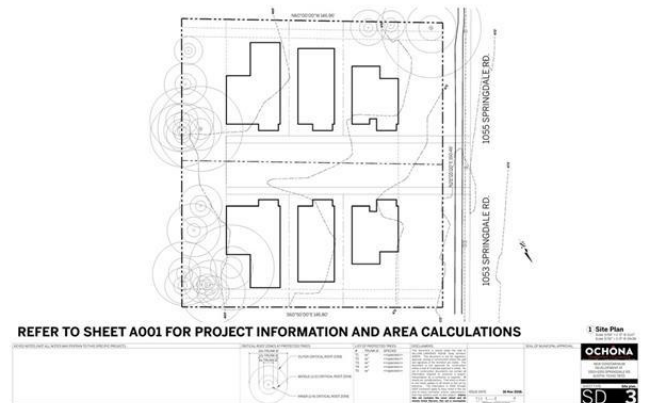

Essential Information

MLS® #	8358498
Price	\$999,000
Square Footage	23,714
Acres	0.54
Type	Lot
Sub-Type	Multiple Lots (Adjacent)
Status	Active

Community Information

Address	1055 Springdale Rd
Region	Austin - East
Subdivision	Prock G C
City	Austin
County	Travis
State	TX
Zip Code	78721

Amenities

Utilities	Electricity Available, Natural Gas Available
View	See Agent

Exterior

Lot Description	Level, See Agent
-----------------	------------------

School Information

District	Austin ISD
Elementary	Govalle
Middle	Martin
High	McCallum

Additional Information

Zoning	Yes
--------	-----

Property Listed by: All City Real Estate Ltd. CoThe information being provided is for consumers' personal, non-commercial use and may not be used for any purpose other than to identify prospective properties consumers may be interested in purchasing. Based on information from the Austin Board of REALTORS® (alternatively, from ACTRIS) from October 17th, 2019 at 12:00am CDT. Neither the Board nor ACTRIS guarantees or is in any way responsible for its accuracy. The Austin Board of REALTORS®, ACTRIS and their affiliates provide the MLS and all content therein "AS IS" and without any warranty, express or implied. Data maintained by the Board or ACTRIS may not reflect all real estate activity in the market. All information provided is deemed reliable but is not guaranteed and should be independently verified.